

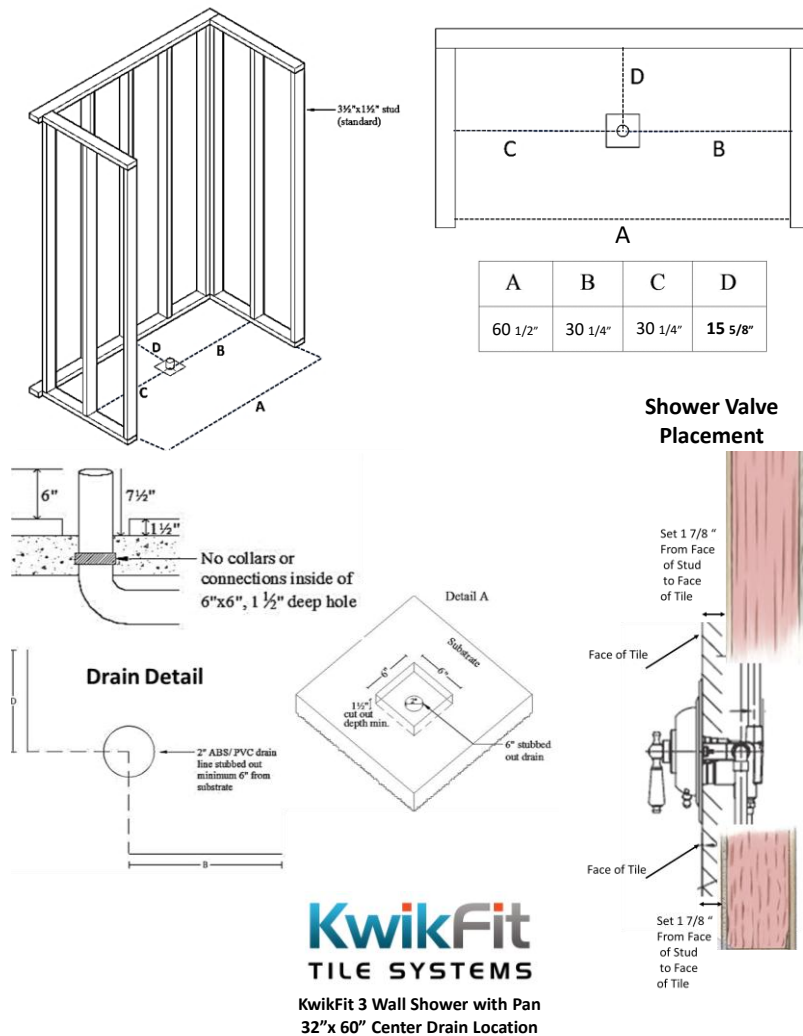

KwikFit Tile Systems Installation Instructions

1. Verify RO Framing Dimensions are within required tolerances and 2" PVC/ABS drain pipe is located correctly. (See RO dimensional drawing Ins No. 1)
2. Verify that shower area substrate is level within acceptable tolerance ¼" max. Measure 2" PVC/ABS drain waste pipe is at a correct height 1/8", above high point of shower base area.
3. Dry fit shower base level. Double check all dimensions, make sure 2" PVC/ABS drain waste pipe is within correct range for connection to drain assembly on shower base. (See Attached drawing No.2)
4. Apply Supplied Mapei RS adhesive and work shower base into correct and level location over 2" PVC/ABS waste drain, allow to cure.
5. Connect and tighten drain locking nut with rubber compression ring (See attached drawing No.3) It is recommended to plug drain waste pipe and fill shower base for 24 hours to check for leaks.
6. Install Kwikboards to framing/substrate attached method to be min 1 5/8" drywall screws with wafer washer max spacing 12" on center. Repeat process for all boards within shower/tub wet area.
7. Install 2" waterproof band with thinset or polyurethane adhesive/sealant to all vertical and horizontal seams.
8. Apply polyurethane sealant to cover all washers and screws.
9. If Kwikfit ABS niche box is used apply 2" waterproof band with polyurethane sealant around perimeter flange to kwikboard connections.
10. If window or seats are within the wet shower/tub area install 2" waterproof band with polyurethane sealant to all joints.

DRAWING NO 1



Drawing No 3

TILE PAN INSTALLATION

KwikFit



Install rubber gasket and caulking nut hand tight and then 1/4 turn with key.



Completed drain connection with waste pipe slightly below no caulk compression nut.

TILE PAN INSTALLATION

KwikFit



Verify shower pan is level in all 4 corners.